

**HN ULTIMATE**  
11-06-08  
EFFECTIVE S/N 200802281

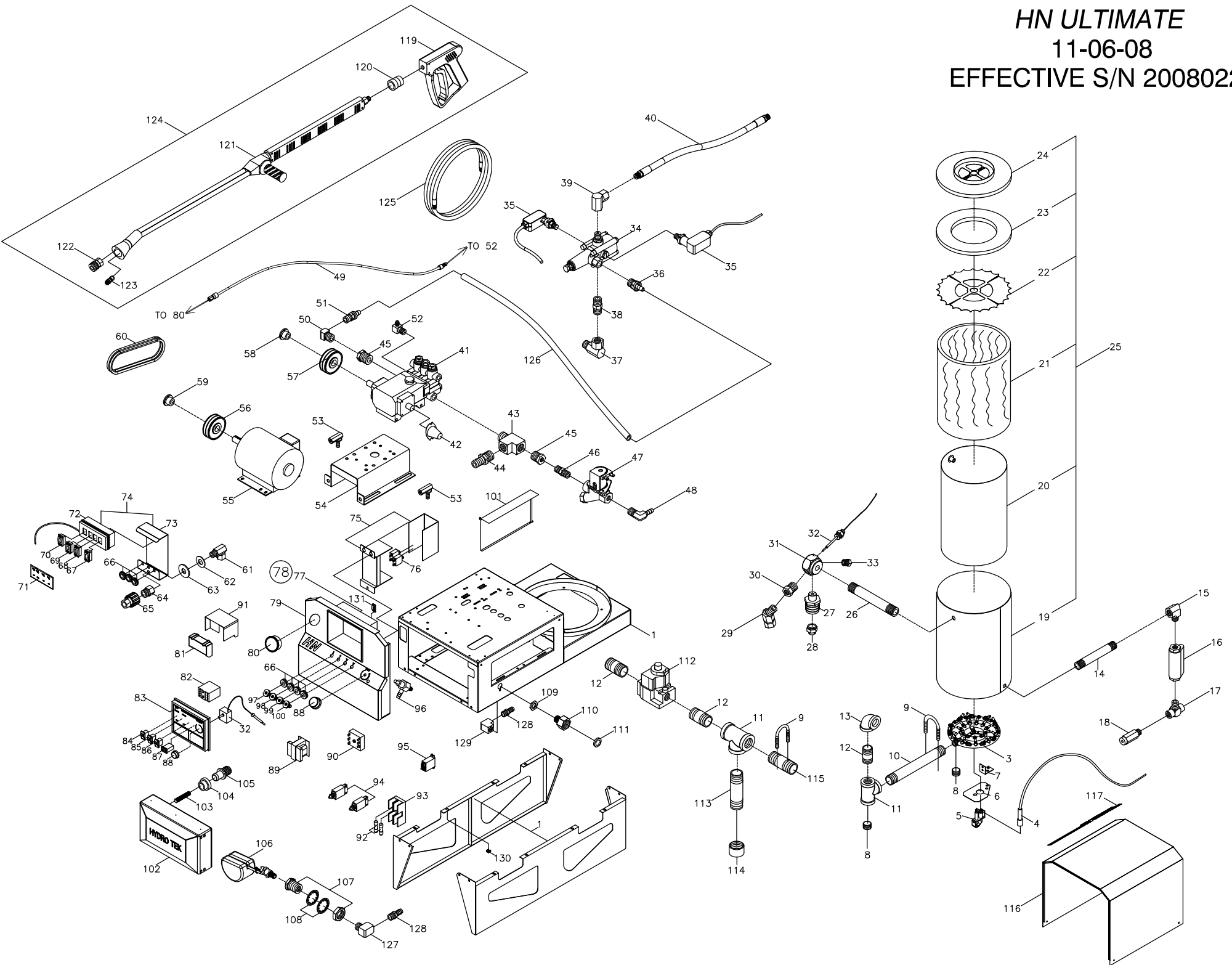

# HN ULTIMATE LINE PARTS LIST

1	HNG51	HN FRAME ASSEM STAINLESS STEEL (2008) 4 PIECE	ALL
3	BGW70	X44 BURNER RING W/JETS NAT GAS	ALL
4	BGW36	IGNITION WIRE 47" NG/HN ASM	ALL
5	BGP10	PILOT ASM. HW.	ALL
6	HNG31	HN PILOT SHEILD STAINLESS	ALL
7	HNG32	HN PILOT BRACKET STAINLESS	ALL
8	DP012	PLUG 3/4" STEEL COUNTER SINK HO.	ALL
9	FB990	U BOLT 1/4"-20 x 13/4"	ALL
10	DGN18	NIPPLE 3/4"x 8" BLACK SCH 40	ALL
11	DGT12	TEE 3/4" BLACK	ALL
12	DGN00	NIPPLE 3/4" CLOSE BLACK	ALL
13	DGL12	ELBOW 3/4" BLACK PIPE	ALL
14	BC860	NIPPLE 1/2" x 6" STD BLACK PIPE	ALL
15	DE586	STREET ELL 1/2"F x 3/8"M STEEL	ALL
16	VS005	FLOW SWITCH 8@ 4200 ST5	ALL
17	DEB66	BRANCH TEE 3/8" STEEL	ALL
18	UP128	PRESSURE RELIEF 2800PSI BLUE	HN20004E2R,E8R,HN21004E3R,E4R,HN22005E2R
	UP137	PRESSURE RELIEF 3700PSI BLACK	HN32004E2R
	UP045	PRESSURE RELIEF 4500+15% 500q	HN35005E3R,E4R,E8R
19	HNG49	HN COIL WRAP ASM (2003)	ALL
20	BC780	COIL 7 PK 20in VERTICAL	ALL
21	BN053	INSUL BLKT 50SQ' 1/2 x 24 8# 25'	ALL
22	HHN27	HN INSULATION RETAINING RING	ALL
23	BN053	INSUL BLKT 50SQ' 1/2 x 24 8# 25'	ALL
24	HNG28	HN COIL CAP ASM	ALL
25	BC787	COIL ASM 7PK 20in (2003 MODELS)	ALL
26	BC845	BURNER NIPPLE 1/2" x 4 1/2" SCH 80	ALL
27	UPB05	ADAPTER FITTING-BURST DISC	ALL
28	UPB80	BURST DISC 8000 PSI TORQUE 32-4	ALL
29	DE606	SWIVEL 45 3/8"M x 3/8"F STEEL	ALL
30	DA086	BUSHING 1/2" x 3/8" STEEL	ALL
31	HHA00	HEX MANI OUTLET 1/2" x 1/2" NO REEL	ALL
32	ECH50	THERMOSTAT; 60-250 1 GP PART=25	ALL
33	D1060	PLUG 3/8" BRASS	ALL
34	UU370	UNLOADER 2-4 @ 3200 K7-0	ALL
35	VS030	PRESSURE SWITCH 4000 PA/PR16]	ALL
36	D6062	HOSE BARB, PUSH LOCK 3/8"H x 3/8"	ALL
37	DE866	SWIVEL 3/8"F x 3/8"M 90	ALL
38	DB506	NIPPLE 3/8" STEEL	ALL
39	DE766	SWIVEL 3/8"F x 90 STEEL (BRAZE)	ALL
40	DH007	HOSE 3/8" x 48" 5000 PSI	ALL
41	P4022	PUMP 3CP1120 @ 2200 SHAFT 16	HN20004E2R,E8R,HN21004E3R,E4R,HN22005E2R
	P4535	PUMP 5CP3120 4.5 @3500 20MM	HN32004E2R,HN35005E3R,E4R,E8R
42	PP692	SHAFT PROTECTOR 5 FRAME BD PMP	ALL
43	D6588	STREET TEE 1/2" BRASS	ALL
44	D8074	HOSE BARB 5/8"H x 1/2"M .322id BRN	HN20004E2R,E8R
	D8076	HOSE BARB 5/8"H x 1/2"M .339id PNK	HN21004E3R,E4R,HN22005E2R,HN35005E3R,E4R,E8R
	D8072	HOSE BARB 5/8"H x 1/2"M .281id BLU	HN32004E2R
45	D1084	BUSHING 1/2" x 1/4" BRASS	ALL
46	D2044	NIPPLE 1/4" BRASS	ALL
47	ECVO5	SOAP SOLENOID VALVE W/COIL	ALL
48	D8040	HOSE BARB 1/4" 90 ELBOW	ALL
49	DH130	HOSE 1/4" x 25" 5000PSI HN GA HN 2003 MODELS	ALL
50	D5544	STREET ELL 1/4" BRASS (COMPACT)	ALL
51	D6064	HOSE BARB, PUSH LOCK 3/8"H x 1/4"	ALL
52	D5546	STREET ELL 3/8"MPT x 1/4"JIC	ALL
53	HRP60	PUMP RAIL BOLT	HN20004E2R,E8R,HN21004E3R,E4R,HN22005E2R
54	HHD03	HD PUMP SUPPORT RAIL 14 GA SS	HN20004E2R,E8R,HN21004E3R,E4R,HN22005E2R
	HPR55	ADJUSTMENT BRKT-PUMP (2003 HN)	HN32004E2R,HN35005E3R,E4R,E8R
	HSS21	PUMP SPACER 1/2" x 5/8"od x 5/16"ID	HN32004E2R,HN35005E3R,E4R,E8R
55	ME504	MOTOR 5HP 208/230V 1 PH 3450rpm	HN20004E2R,HN20004E8R
	ME605	MOTOR 6HP 230/460 3PH MAGNETEK	HN21004E3R,HN21004E4R
	ME606	MOTOR 6.5HP 230V 1PH 3450 MT 3	HN22005E2R
	ME752	MOTOR 7.5HP 230V 1PH 32a	HN32004E2R
	ME903	MOTOR 10HP 1750r 200-230/460 3PH	HN35005E3R,E4R,E8R
56	KU036	SHEAVE BK36H	HN20004E2R,E8R,HN21004E3R,E4R,HN22005E2R
	KU045	SHEAVE 2BK45H	HN32004E2R
	KU050	SHEAVE 2BK50H	HN35005E3R,E4R,E8R
57	KU080	SHEAVE BK80H	HN20004E2R,E8R,HN21004E3R,E4R,HN22005E2R
	KU057	SHEAVE 2BK57H	HN32004E2R
	KU055	SHEAVE 2BK55H	HN35005E3R,E4R,E8R
58	KSH15	BUSHING HX 1.6 5MM	HN20004E2R,E8R,HN21004E3R,E4R,HN22005E2R
	KSH17	BUSHING H 20MM	HN32004E2R,HN35005E3R,E4R,E8R
	KSH12	BUSHING H 3/4	HN20004E2R,E8R,HN22005E2R
	KSH14	BUSHING H 7/8	HN21004E3R,HN21004E4R
	KSH20	BUSHING Hx 1 3/8 5/16	HN32004E2R,HN35005E3R,E4R,E8R
60	KSB38	BELT BX38	HN20004E2R,HN20004E8R
	KSB4X	BELT BX40	HN21004E3R,E4R,HN22005E2R
	KSB35	BELT BX35	HN32004E2R,HN35005E3R,E4R,E8R
61	DE866	SWIVEL 3/8"F x 3/8"M 90	ALL
62	FWS09	WASHER 11/16"ID x 1 1/2"OD STNLS	ALL
63	FWC17	WASHER 11/16"ID PLD SAE	ALL

# 11-06-08 EFFECTIVE S/N 200802281

64	DQ76F	TWIST COUPLER 3/8" PLUG FEM	ALL
65	DQ76S	TWIST COUPLER 3/8" SOCK FEM	ALL
66	HLB09	GROMET NOZZLE HOLDER	ALL
67	EC498	ROCKER SWITCH COVER-GREEN	ALL
68	EC406	ROCKER SWITCH 24V RED SPST	ALL
69	EC495	ROCKER SWITCH COVER-AMBER	ALL
70	EC450	ROCKER SWITCH MOMENT. W/NO LED	ALL
71	GLL99	LABEL 4 SWITCH REM.-HN 5 MIL 4	ALL
72	HHN25	LAS CUT ELCT BOX HNR REMOTE	ALL
73	HCW10	CW REMOTE BOX WALL BRACKET	ALL
74	AEN25	HN REMOTE TYPE A ASM	ALL
75	ECT05	TRANSFORMER 460/230V 100VA BOX	HN21004E4R,HN35005E4R
76	ECF03	3 AMP BREAKERS	HN21004E4R,HN35005E4R
77	EWB72	ELECTRICAL BOX 10" x 8" x 6" HINGED	ALL
78	EHN23	HN COMBO BOX HN21004R3 (2003)	HN20004E8R,HN21004E3R
	EHN24	HN COMBO BOX HN21004R4 (2003)	HN21004E4R
	EHN41	HN COMBO BOX HN32004E2R (2003)	HN32004E2R
	EHN43	HN COMBO BOX HN35005E3R (2003)	HN35005E3R,E8R
	EHN45	HN COMBO BOX HN35005R4 (2003)	HN35005E4R
79	HNG46	HN CONTROL PANEL CUT GROUP-PRO	ALL
80	UG055	GAUGE; 5000PSI DUAL SCALE: PN	ALL
81	BGG15	IGNITION MODULE HW 90 SECOND	ALL
82	EA053	STARTER 230V 3 PH 17-25 AMP	HN20004E8R,HN21004E3R,HN35005E4R
	EA054	STARTER 460V 3 PH 6 HP 9-13 AMP	HN21004E4R
	EA100	STARTER 230V 3POLE 40-52amp	HN32004E2R
	EA103	STARTER 230V 3 PH 23-32 AMP TWO	HN35005E3R,E8R
83	GLL94	LABLE CON BOX HN 5 MIL 9.25" x 7"	ALL
84	EC450	ROCKER SWITCH MOMENT. W/NO LED	ALL
85	EC495	ROCKER SWITCH COVER-AMBER	ALL
86	EC406	ROCKER SWITCH 24V RED SPST	ALL
87	EM603	HOUR METER 220V	ALL
88	ECH70	KNOB; BLUE .25id x 1.5od	ALL
89	BGT10	TRANSFORMER 120/230-24V 40VA	ALL
90	ECD24	TIME DELAY 24V ADJ 300 SECOND	ALL
91	HNG08	IGNITION MODULE SHEILD	ALL
92	EF025	1/4 AMP MINI DELAY FUSE	HN21004E4R,HN35005E4R
93	EFB02	FUSE BLOCK 2 POLE MINI FUSE	HN21004E4R,HN35005E4R
94	ECF05	CIRCUIT BREAKER 1/2 AMP	HN20004E2R,E8R,HN21004E3R,HN22005E2R
			HN32004E2R,HN35005E3R,E8R
95	ECC08	RELAY; 24VOLT SPST 50/60 Hz	ALL
96	VVC10	CHEMICAL MET VALVE MV-100 MOD	ALL
97	NQ400	NOZZLE/QDC 04 x 0	HN32004E2R
	NQ450	NOZZLE/QDC 045 x 0	HN35005E3R,E4R,E8R
	NQ550	NOZZLE/QDC 055 x 0	HN20004E2R,E8R,HN21004E3R,E4R,HN22005E2R
98	NQ402	NOZZLE/QDC 04 x 15	HN32004E2R
	NQ452	NOZZLE/QDC 045 x 15	HN35005E3R,E4R,E8R
	NQ552	NOZZLE/QDC 055 x 15	HN20004E2R,E8R,HN21004E3R,E4R,HN22005E2R
99	NQ404	NOZZLE/QDC 04 x 40	HN32004E2R
	NQ454	NOZZLE/QDC 045 x 40	HN35005E3R,E4R,E8R
	NQ554	NOZZLE/QDC 055 x 40	HN20004E2R,E8R,HN21004E3R,E4R,HN22005E2R
100	NQ303	NOZZLE/QDC 03 x 25	HN32004E2R
	NQ353	NOZZLE/QDC 035 x 25	HN35005E3R,E4R,E8R
	NQ453	NOZZLE/QDC 045 x 25	HN20004E2R,E8R,HN21004E3R,E4R,HN22005E2R
101	HHN59	BELT GUARD (HN 2003)	ALL
102	WT040	TANK; FLOAT 4 GAL HD LINEAR	ALL
103	VF050	STRAINER TUBE FOR FLOAT TANK	ALL
104	DFF10	WATER TANK BUSHING 5/8"	ALL
105	DQF10	DISCONNECT BARB/TANK FITTING	ALL
106	VVF08	FLOAT VALVE 3/8" BRASS	ALL
107	D7520	PANEL FITTING 3/4" BRASS	ALL
108	FW700	WASHER LOCK 1"GALV	ALL
109	D7061	HEX NUT 3/8" BRASS-REMOTE UNLOADER	ALL
110	D006M	GARDEN HA 3/8" NPT MALE	ALL
111	D0021	SCREEN WASHER GARDEN HA	ALL
112	BGV07	NATURAL GAS VALVE 3/4"	ALL
113	DGN10	NIPPLE 3/4" x 3 1/2" BLACK	ALL
114	DGPC2	PIPE CAP 3/4" BLACK	ALL
115	DGN05	NIPPLE 3/4" x 2 1/2" BLACK	ALL
116	HNG47	HN SWING UP COVER-(2003)	ALL
117	GLL75	LABEL HYDRO TEK 34 x 3.00 PRESS STEAM	ALL
119	VG200	TRIGGER GUN, INSULATED 4000PSI	ALL
120	ECH75	HEAVY DUTY BEND RESTICTOR-B	ALL
121	VWD42	DUAL WAND W/HANDLE, STAINLESS	ALL
122	DQ04T	COUPLER 1/4" SOCK MALE	ALL
123	NN982	NOZZLE 30 x 15 BRASS	ALL
124	AVWA3	ULTRA GUN/WAND 48" S/HNDL ADJ	ALL
125	DH060	HOSE 3/8" x 50' BLU/GRY 25	ALL
126	DHP06	HOSE; 3/8" PUSH LOCK 34"	ALL
127	D5566	STREET ELL 3/8" BRASS	ALL
128	D8068	HOSE BARB 1/2H x 3/8P BRASS	ALL
129	D5066	ELL 3/8 BRASS	ALL
130	FNS05	5/16 -18 SQUARE SPEED NUT	ALL
131	EC116	SWITCH, SLIDE 1P2T	HN30008E3R,HN35005E3R
	BGV05	NP TO LP CONVERSION INSTALL 440K	OPTIONAL